

HYDRAULICALLY OPERATED, SHEAR AND SEAL REVOLUTION VALVE WITH INTEGRAL POWERPLUS ACCUMULATOR, DESIGNED WITH HIGH CUTTING PERFORMANCE AND RELIABLE POST-CUT SEALING.

Features:

- ▷ Unidirectional valve with pump-through capability.
- ▷ Integral PowerPlus Accumulator to maintain cutting performance after cutting the shear sub.
- ▷ Separate cutting and sealing components in a single device.
- ▷ Compact & lightweight design.

DESIGN DATA

Nominal Bore Diameter	6 1/8" (155.6 mm)
Design Pressure	Working: 15,000 psi (103.4 MPa) Test: 22,500 psi (155.1 MPa)
Design Standards	API 6A 20 th Edition (ISO 10423) 2010, ISO 13628-7 2006, API 17G 3 rd Edition 2019, NACE MR0175-2015
Temperature Class (Design)	API 6A Class U (0°F to 250°F / -18°C to +121°C)
Service	CO ₂ , H ₂ S (NACE MR 0175 / ISO 15156)
Material Class	HH
Product Specification Level	PSL 3G
Shearing Class	Wireline / Coiled Tubing Shear and Seal

PERFORMANCE DATA

Maximum Hydraulic Pressure	10,000 psi (68.9 MPa)
Actuator Volume (Total, Approx.)	0.4 U.S. gallons (1.5 Litres)
Acceptable Hydraulic Fluid	Any water or oil-based control fluid
Wireline Cutting Capabilities	All common slickline, e-line and braided cable grades
Coiled Tubing Cutting Capabilities	<p><u>Tested</u> 1.75" OD x 0.203" wall thickness, QT-1300 Coiled Tubing c/w 5/16" EEHS Cable</p> <p><u>Indicative Predicted</u> 110ksi min yield, up to 2 3/8" x 0.224" wall thickness 130ksi min yield, up to 2 3/8" x 0.203" wall thickness 130ksi min yield, up to 2" x 0.203" wall thickness</p>

WEIGHT AND DIMENSIONS

Overall Height (Nominal)	40.625" (1 032.0 mm)
Overall Diameter (Nominal)	18.625" (473.0 mm)
Gross Dry Weight (Approx.)	2,381 lb (1 080 kg)

STANDARD INTERFACES

Upper End Connection	10.250"-4 TPI Stub Acme Box c/w Elastomeric Seal
Lower End Connection	15.000"-4 TPI Stub Acme Box c/w Elastomeric Seal

STRUCTURAL CAPACITIES

Maximum Tension @ RWP	1,565 kip
Maximum Moment @ RWP	331.8 ft kip
Maximum Tension @ 0 ksi	2,629 kip
Maximum Moment @ 0 ksi	557.3 ft kip

VALIDATION LEVEL

Service Specification Level	API 17G SSL-Gas
Temperature Class (Operational)	0°C to +92°C
Water Depth	Static - 10,000 ft (3,048 m) Functional – 2,133 ft (650 m)
Shearing	API 17G Shear and Seal Class

NOTES

This valve is not designed with differential pressure breakout capability.

PRODUCT LAYOUT DRAWING

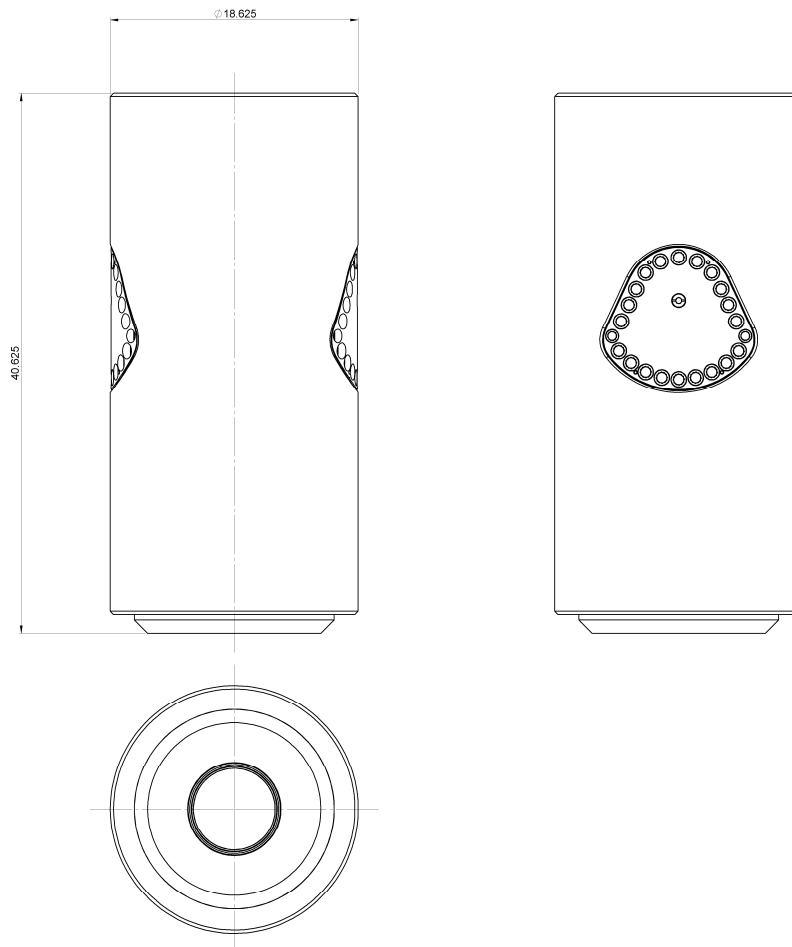

Document Reference

The information in this document is uncontrolled and subject to change without notice.

CONTACT US: Interventek Subsea Engineering Ltd.

Unit 4 International View, ABZ Business Park, Dyce, ABERDEEN AB21 0BJ

  +44 (0)1224 518 509 enquiries@interventek.com www.interventek.com

